

STANDARD CLEVIS HANGER DIMENSIONS

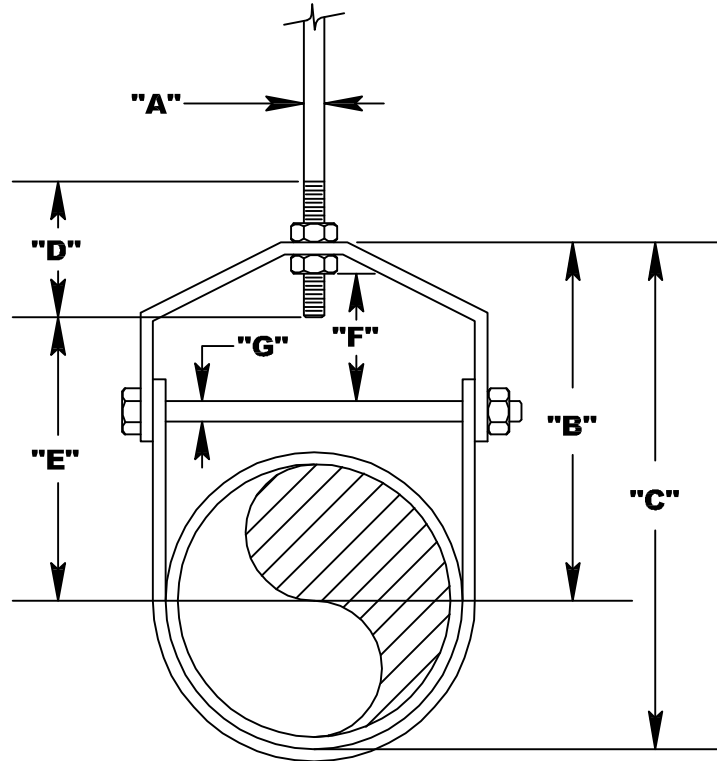

PIPE SIZE	MAXIMUM ALLOWABLE LOAD-LBS.	ROD SIZE A	B	C	D	E	ADJ. F	G
1/2"	610	3/8"	1-15/16"	2-3/8"	1-1/2"	15/16"	3/8"	3/8"
3/4"	610	3/8"	1-15/16"	2-9/16"	1-1/2"	1-1/8"	1/2"	3/8"
1"	610	3/8"	2-1/8"	2-13/16"	1-3/4"	1-3/8"	5/8"	3/8"
1-1/4"	610	3/8"	2-5/16"	3-3/16"	1-3/4"	1-13/16"	5/8"	3/8"
1-1/2"	610	3/8"	2-11/16"	3-11/16"	2"	2-1/4"	7/8"	3/8"
2"	610	3/8"	3-3/16"	4-7/16"	2-1/4"	2-15/16"	1-1/8"	3/8"
2-1/2"	1,130	1/2"	3-7/8"	5-3/8"	2-1/2"	3-9/16"	1-5/16"	1/2"
3"	1,130	1/2"	4-11/16"	6-1/2"	3"	3-13/16"	1-13/16"	1/2"
3-1/2"	1,130	1/2"	4-15/16"	7"	3"	4-1/16"	1-13/16"	1/2"
4"	1,430	5/8"	5-3/16"	7-9/16"	3-1/4"	4-5/16"	1-11/16"	5/8"
5"	1,430	5/8"	6-1/16"	8-15/16"	3-1/2"	5-1/8"	1-7/8"	5/8"
6"	1,930	3/4"	6-13/16"	10-3/16"	3-3/4"	5-11/16"	1-7/8"	3/4"
8"	2,000	3/4"	8-1/8"	12-1/2"	4"	7"	2-1/16"	3/4"
10"	3,600	7/8"	9-1/2"	15"	4"	8-5/16"	1-7/8"	7/8"
12"	3,800	7/8"	11-1/8"	17-5/8"	4-1/2"	9-11/16"	2-3/16"	7/8"
14"	4,200	1"	12-3/8"	19-1/2"	5-1/4"	10-3/4"	2-11/16"	1"
16"	4,600	1"	13-13/16"	21-15/16"	5-1/2"	11-9/16"	2-3/4"	1"
18"	4,800	1"	15-3/4"	24-7/8"	6-1/2"	14"	3-7/8"	1"
20"	4,800	1-1/4"	17-3/8"	27-1/2"	7"	15-1/4"	3-7/8"	1-1/4"
24"	4,800	1-1/4"	19-5/8"	31-3/4"	7-1/4"	17-1/2"	4-7/8"	1-1/4"

The technical data in this document is based on information believed to be accurate. Nothing contained herein should be considered a recommendation for the use. All risk of liability rests on the user of the data.